

Product Sheet



Item No. F H P 5 4 W C 125 B A U 5 D 0 N

housing / data

housing type fixed castor
 series heavy duty
 fixing type fixing plate
 hole dimensions / hub width 105 x 80 mm / 60 mm
 thickness of fixing / fork 4.00 mm / 4.00 mm
 surface treatment galvanized blue zinc



wheel / data

diameter 125 mm
 wheel center Aluminium (Heavy Duty)
 wheel tread Polyurethane brown
 bearing double ball bearing
 threadguard no separate threadguard
 hub width 60 mm
 axle diameter M 12
 temperature range -20°C - +60°C
 dyn. load capacity 400 kg
 test norm DIN: EN 12533

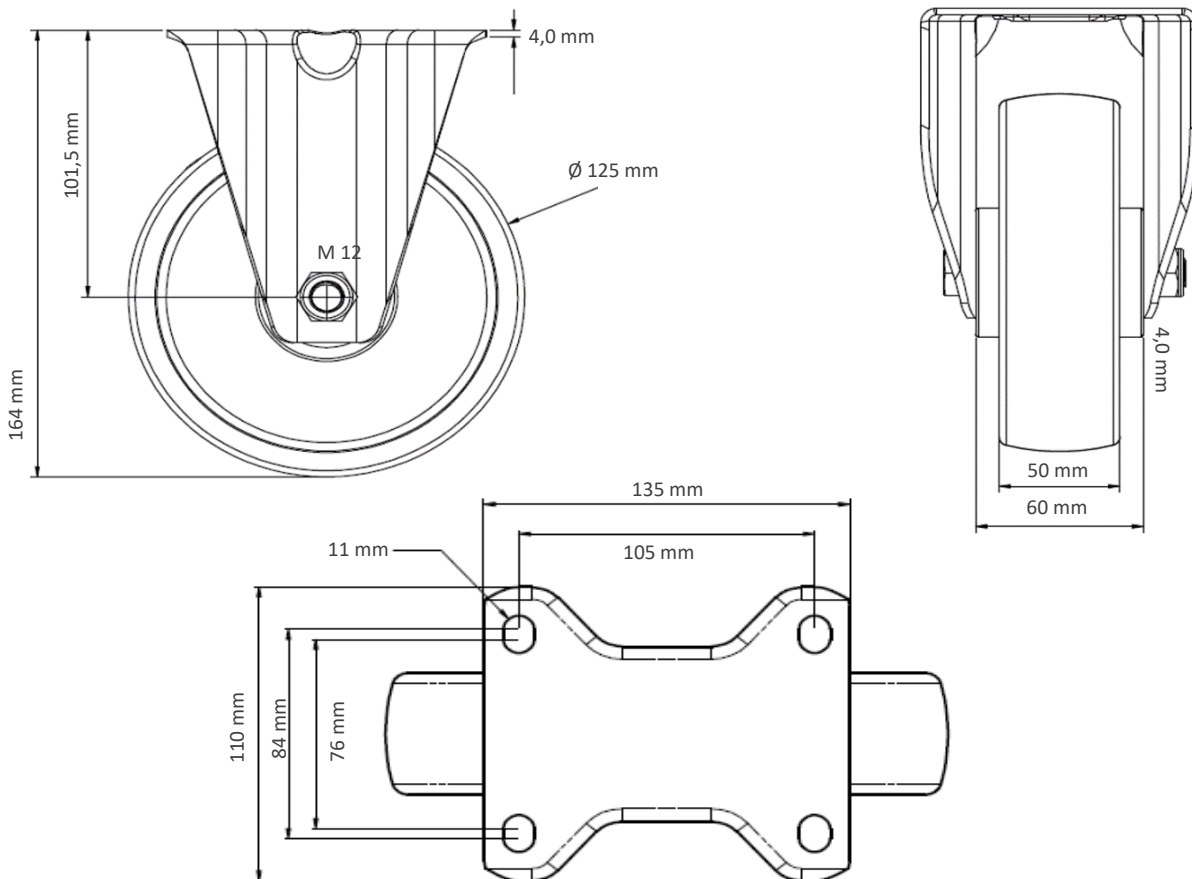
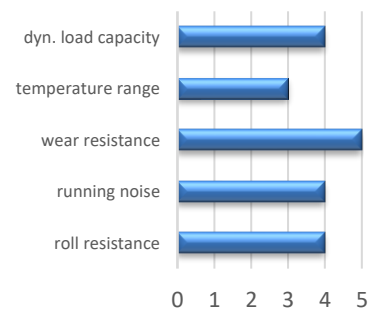

Deviation possible! All information is subject to change.