

# Product Sheet



Item No. F P P 5 5 W C 200 P 2 G 2 B 3 2

## housing / data

housing type	fixed castor
series	CASCOO Premium
fixing type	fixing plate
hole dimensions / hub width	105 x 80 mm / 60 mm
thickness of fixing / fork	2.50 mm / 2.50 mm
surface treatment	galvanized blue zinc



## wheel / data

diameter	200 mm
wheel center	Polypropylene grey
wheel tread	thermopl. rubber 65° Shore A grey
bearing	single ball bearing
threadguard	small plastic threadguard
hub width	59 mm
axle diameter	M 12
temperature range	-20°C - +60°C
dyn. load capacity	250 kg
test norm	DIN: EN 12532

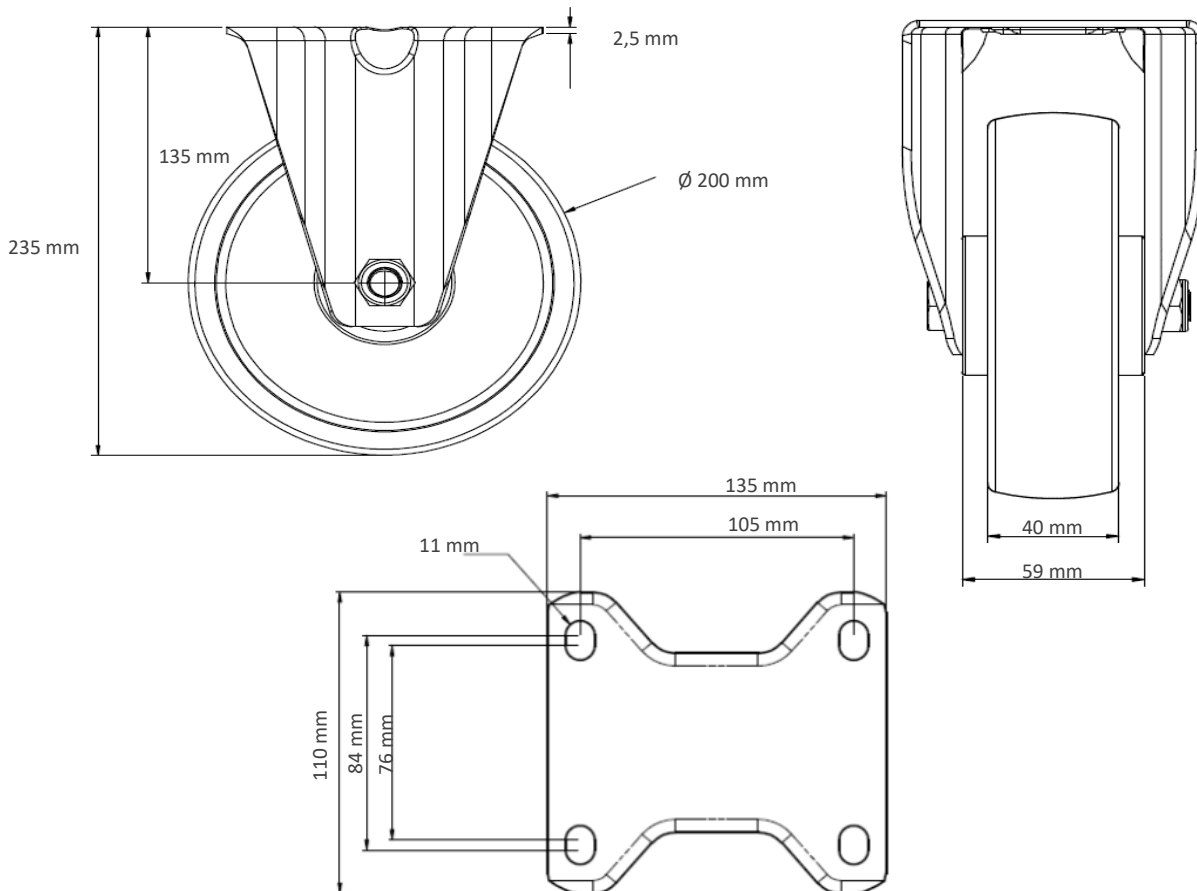
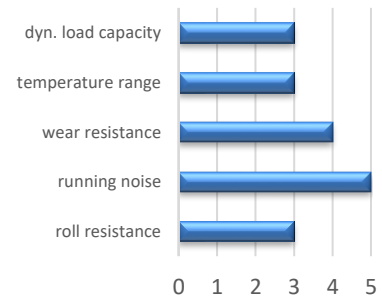

Deviation possible! All information is subject to change.